

NOTES:  
 1. DO NOT SCALE. USE FIGURED DIMENSIONS ONLY.  
 2. THIS DRAWING IS TO BE READ IN CONJUNCTION WITH ALL OTHER RELEVANT ARCHITECTURAL AND ENGINEERING DRAWINGS.

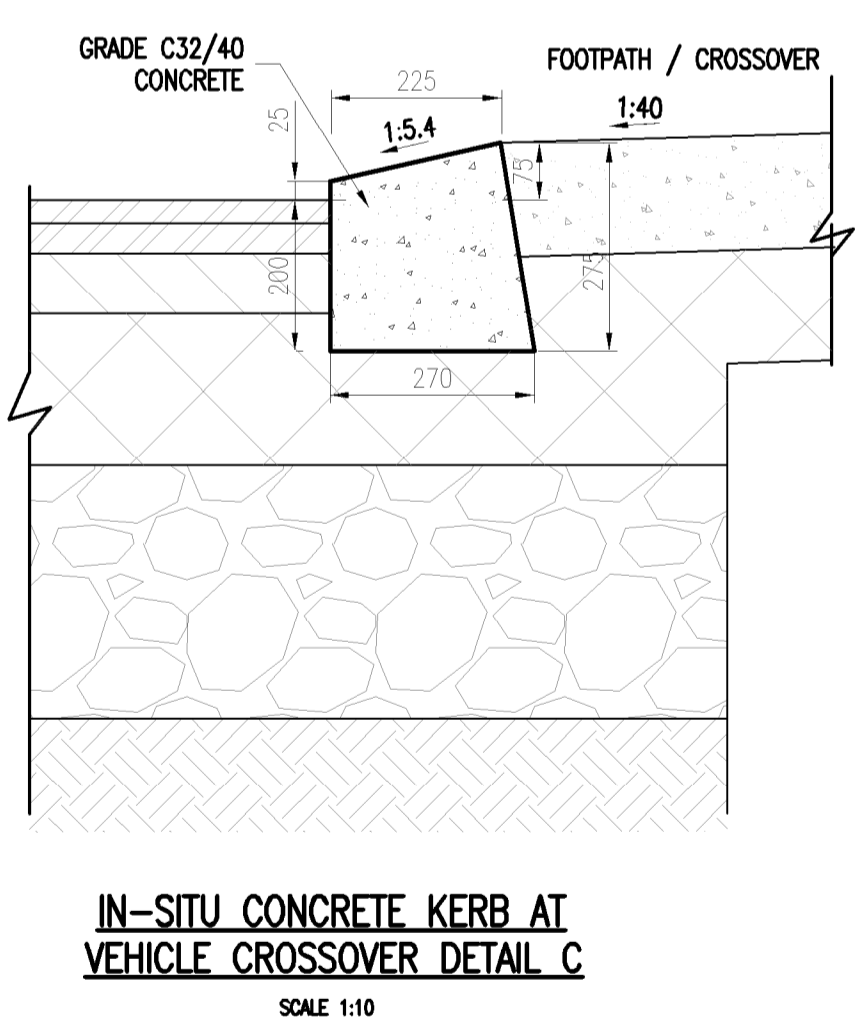
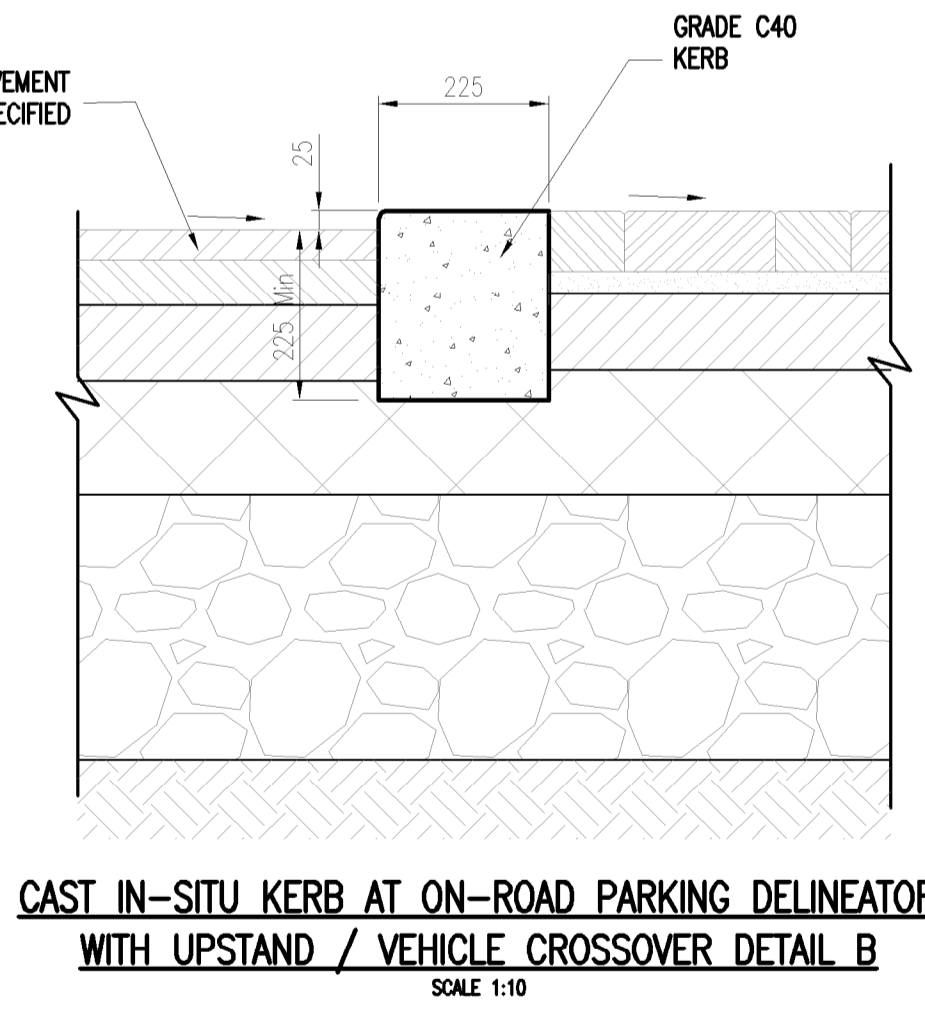
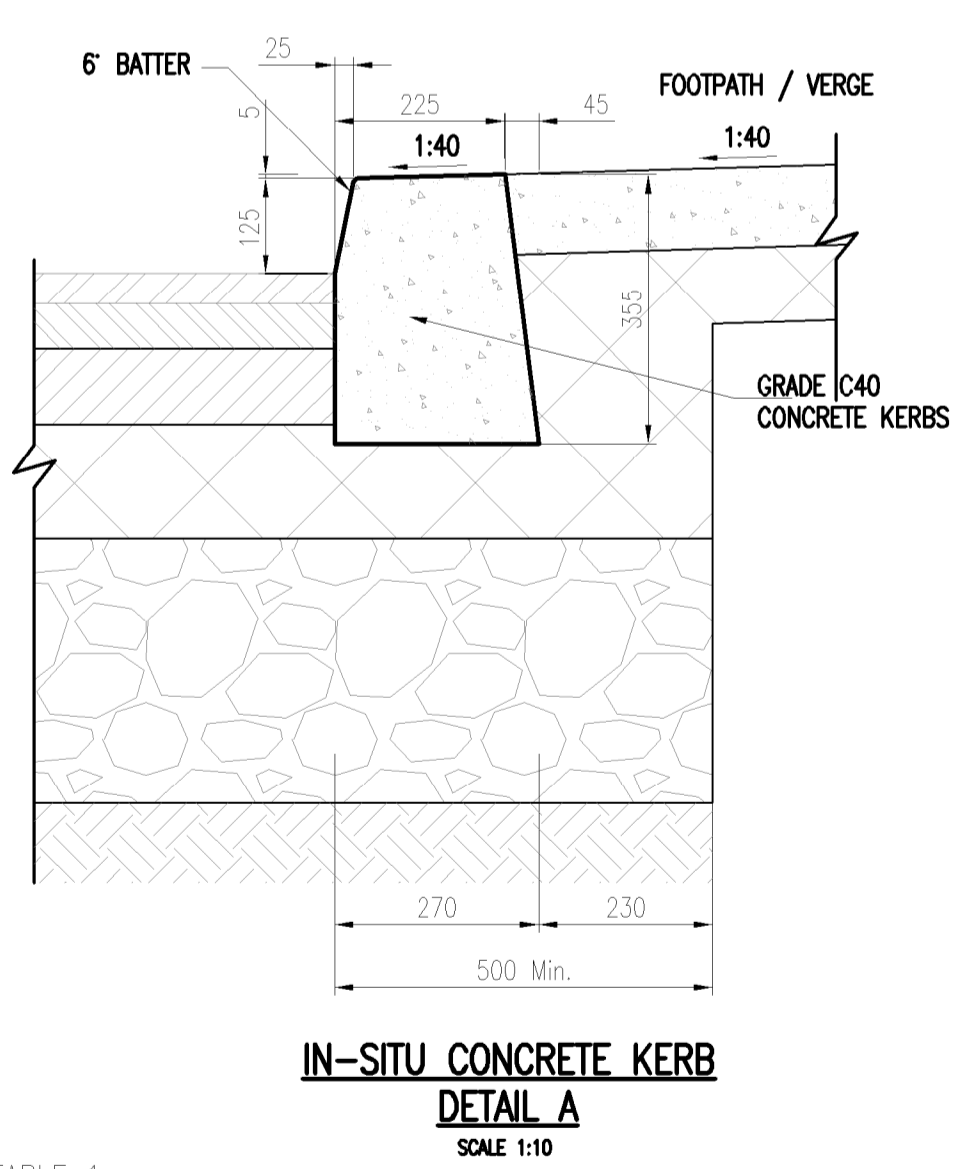
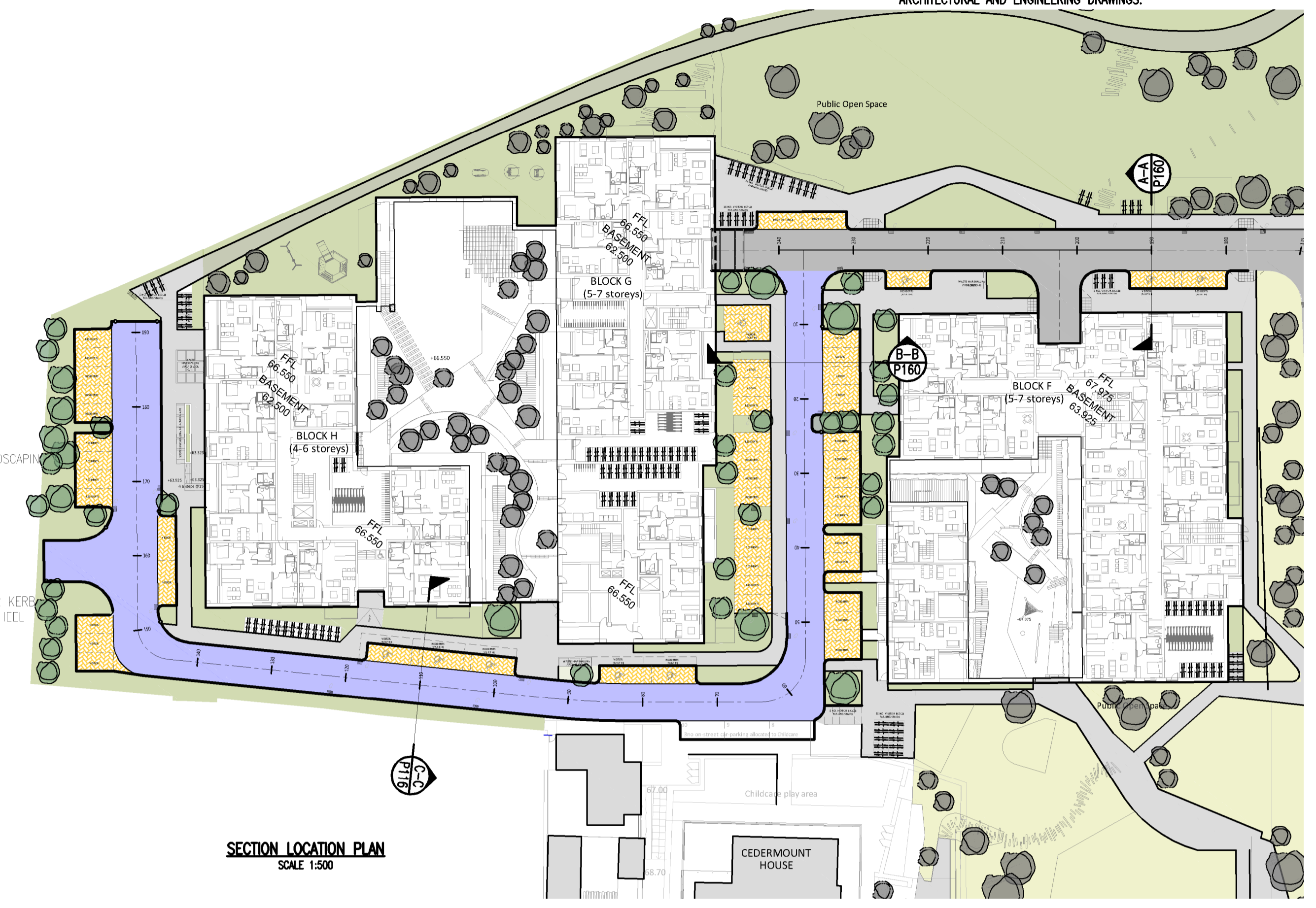
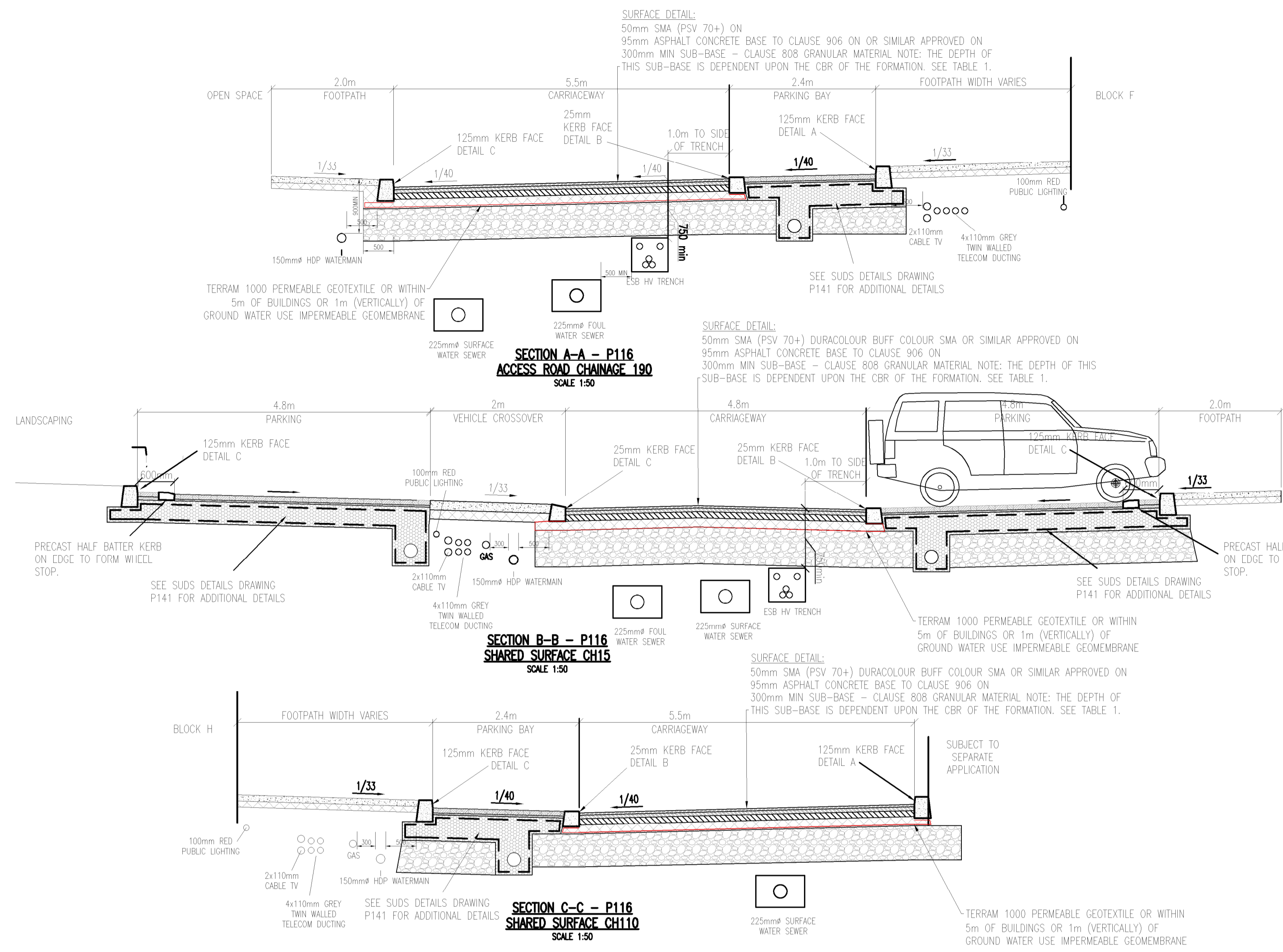

TABLE 1

C.B.R. SUB-GRADE (%)	BELOW 2	2	3	4 or More
THICKNESS OF SUB-BASE (mm)	625	475	350	300
SUB-BASE + CAPPING LAYER COMPRISING				
SUB-BASE THICKNESS (mm)	150		150	
CAPPING LAYER THICKNESS (mm)	600		350	

NOTE:- CAPPING LAYER THICKNESS  
 SITE INVESTIGATION CBR TEST RESULTS INDICATE CBR'S FROM 5.8 TO 8.5. ADDITIONAL TESTS TO BE CARRIED OUT BY THE CONTRACTOR TO BE TAKEN AT A RATE AGREED WITH THE ENGINEER BUT NOT LESS THAN 1 PER 50m.  
 ALL C.B.R. RESULTS TO BE SUBMITTED TO THE ENGINEER PRIOR TO LAYING SUB-BASE FOR APPROVAL.

ACCESS ROAD CONSTRUCTION:-  
 50mm SMA (PSV 70+) ON  
 95mm ASPHALT CONCRETE BASE TO CLAUSE 906 ON OR SIMILAR APPROVED ON  
 300mm MIN SUB-BASE - CLAUSE 808 GRANULAR MATERIAL NOTE: THE DEPTH OF THIS SUB-BASE IS DEPENDENT UPON THE CBR OF THE FORMATION. SEE TABLE 1.

FOOTWAY CONSTRUCTION  
 100mm CONCRETE ON  
 100mm GRANULAR FILL TO CLAUSE 808.  
 VEHICLE CROSSOVER CONSTRUCTION  
 150mm CONCRETE ON  
 150mm GRANULAR FILL TO CLAUSE 808

SHARED SURFACE CONSTRUCTION:-  
 AS PER ACCESS ROAD WITH PROPRIETARY ANTI SKID FINISH

NOTE:  
 1. U3 CONCRETE FINISH INSITU  
 2. CONCRETE KERBS SHALL COMPLY WITH THE RECOMMENDATIONS OF BS 5931 AND SHALL BE PROTECTED FROM ADVERSE WEATHER UNTIL CURED  
 3. EXPANSION AND CONSTRUCTION JOINTS IN KERB TO MATCH JOINTS IN ROADS AND FOOTWAYS  
 4. ALL ROAD WORKS TO BE TO DUN LAOGHAIRE COUNTY COUNCIL STANDARDS FOR TAKING IN CHARGE.

PARKING BAY CONSTRUCTION (FOR TAKING IN CHARGE):-  
 BLOCK PAVING TO BS7533-2 (CATEGORY II)  
 80mm BLOCK PAVING SURFACE COURSE  
 30mm BINDER COURSE - SAND  
 100mm BITUMINOUS BASE - CLOSE GRADED ASPHALT CONCRETE  
 350mm CAPPING LAYER NOTE: THE DEPTH OF THIS SUB-BASE IS DEPENDENT ON THE CBR OF THE FORMATION AND IS TO BE CONFIRMED ON SITE. SEE TABLE 1

A	14/10/21	UPDATED FOR ADDITIONAL INFORMATION	NS
REV. DATE		AMENDMENT	DRN APPD

STATUS  
**PLANNING**

**Waterman Moylan**  
 Engineering Consultants  
 BLOCK 8, EASTPOINT BUSINESS PARK, ALFIE BYRNE ROAD,  
 DUBLIN D03 H3F4 IRELAND. Tel: (01) 664 8900  
 Email: info@waterman-moylan.ie www.waterman-moylan.ie

CLIENT **KNOCKRABO INVESTMENTS DAC**  
 ARCHITECT **OMP ARCHITECTS**  
 PROJECT  
**PHASE 2 RESIDENTIAL DEVELOPMENT AT KNOCKRABO, MT. ANVILLE Rd. DUBLIN 14**

TITLE  
**ROAD CONSTRUCTION DETAILS**

DRAWN NS	DESIGNED RM	APPROVED MD	DATE FEB 2021
SCALE AS SHOWN	JOB NO. 20-086	DRG. NO. P116	REVISION A