

DATE: 21 October 2021
DESIGNER: Alex Naper
PROJECT No: SES 02221 Rev C
PROJECT NAME: Knockrabo - Knockrabo Investments DAC



Residential area designed in accordance with EN13201-2:2015
Category P4.

Rev A - Updated as per comments.
Rev B: Client name updated.
Rev C: Updated site layout.

Outdoor Lighting Report

PREPARED BY: Sabre Electrical Services Ltd.
Unit 11,
Bellview Industrial Estate,
Tolka Valley Road,
Dublin 11
Phone Number: 01 8110875
Contact: Graham Sheehan
eMail: graham@sabrelighting.ie

Layout Report

General Data

Dimensions in Metres Angles in Degrees

Calculation Grids

ID	Grid Name	X	Y	X' Length	Y' Length	X' Spacing	Y' Spacing
1	Grid 1	718208.00	728429.00	277.00	291.00	1.50	1.50
2	Grid 2	718391.00	728569.00	36.00	36.00	1.50	1.50

Luminaires

Luminaire A Data

Supplier	
Type	BGP702 DW52
Lamp(s)	LED-HB 5.2S 727/2700
Lamp Flux (klm)	3.00
File Name	Luma Gen2 Micro_BGP702_DW52_3000_2 0LED_5.2S_CLO_L90_727.ies
Maintenance Factor	0.83
Imax70,80,90(cd/klm)	702.3, 55.2, 0.0
No. in Project	11

Luminaire C Data

Supplier	
Type	BGP702 DX10 BL1
Lamp(s)	LED-HB 5.2S 727/2700
Lamp Flux (klm)	3.00
File Name	Luma Gen2 Micro_BGP702_DX10 BL1_30 00_20LED_5.2S_CLO_L90_727.ies
Maintenance Factor	0.83
Imax70,80,90(cd/klm)	503.9, 72.3, 0.0
No. in Project	2

Luminaire E Data

Supplier	
Type	BGP701 DN25 BL1
Lamp(s)	LED-HB 5.2S 727/2700
Lamp Flux (klm)	1.20
File Name	Luma Gen2 Nano_BGP701_DN25 BL1_12 00_6LED_5.2S_CLO_L90_727.ies
Maintenance Factor	0.83
Imax70,80,90(cd/klm)	702.8, 68.4, 0.0
No. in Project	8

Layout

ID	Type	X	Y	Height	Angle	Tilt	Cant	Out-reach	Target X	Target Y	Target Z
1	A	718363.39	728660.89	6.00	220.00	0.00	0.00	0.40			
2	A	718347.45	728641.65	6.00	127.00	0.00	0.00	0.40			
3	A	718318.68	728619.84	6.00	126.00	0.00	0.00	0.40			
4	A	718311.82	728594.51	6.00	38.00	0.00	0.00	0.40			
5	A	718299.56	728624.24	6.00	297.00	0.00	0.00	0.40			
6	A	718330.37	728571.05	6.00	40.00	0.00	0.00	0.40			
7	A	718316.13	728558.93	6.00	306.00	0.00	0.00	0.40			
8	A	718284.95	728537.31	6.00	312.00	0.00	0.00	0.40			
9	A	718254.25	728521.65	6.00	71.00	0.00	0.00	0.40			

Layout Continued

ID	Type	X	Y	Height	Angle	Tilt	Cant	Out-reach	Target X	Target Y	Target Z
10	A	718249.43	728545.26	6.00	221.00	0.00	0.00	0.40			
11	E	718238.98	728568.82	5.00	329.00	0.00	0.00	0.40			
12	E	718252.15	728593.55	5.00	326.00	0.00	0.00	0.40			
13	E	718265.44	728617.72	5.00	330.00	0.00	0.00	0.40			
14	E	718282.09	728640.67	5.00	323.00	0.00	0.00	0.40			
15	E	718301.73	728657.74	5.00	304.00	0.00	0.00	0.40			
16	E	718325.36	728669.93	5.00	309.00	0.00	0.00	0.40			
17	E	718338.24	728689.98	5.00	333.00	0.00	0.00	0.40			
18	A	718329.92	728643.57	5.00	286.00	0.00	0.00	0.40			
19	C	718404.33	728557.81	6.00	34.00	0.00	0.00	0.40			
20	C	718412.39	728572.99	6.00	305.00	0.00	0.00	0.40			
21	E	718429.85	728530.90	5.00	294.00	0.00	0.00	0.40			

Horizontal Illuminance (lux)

Grid 1



Results

Eav	5.47
Emin	1.08
E _{max}	15.44
E _{min} /E _{max}	0.07
E _{min} /E _{av}	0.20

Horizontal Illuminance (lux)

Grid 2

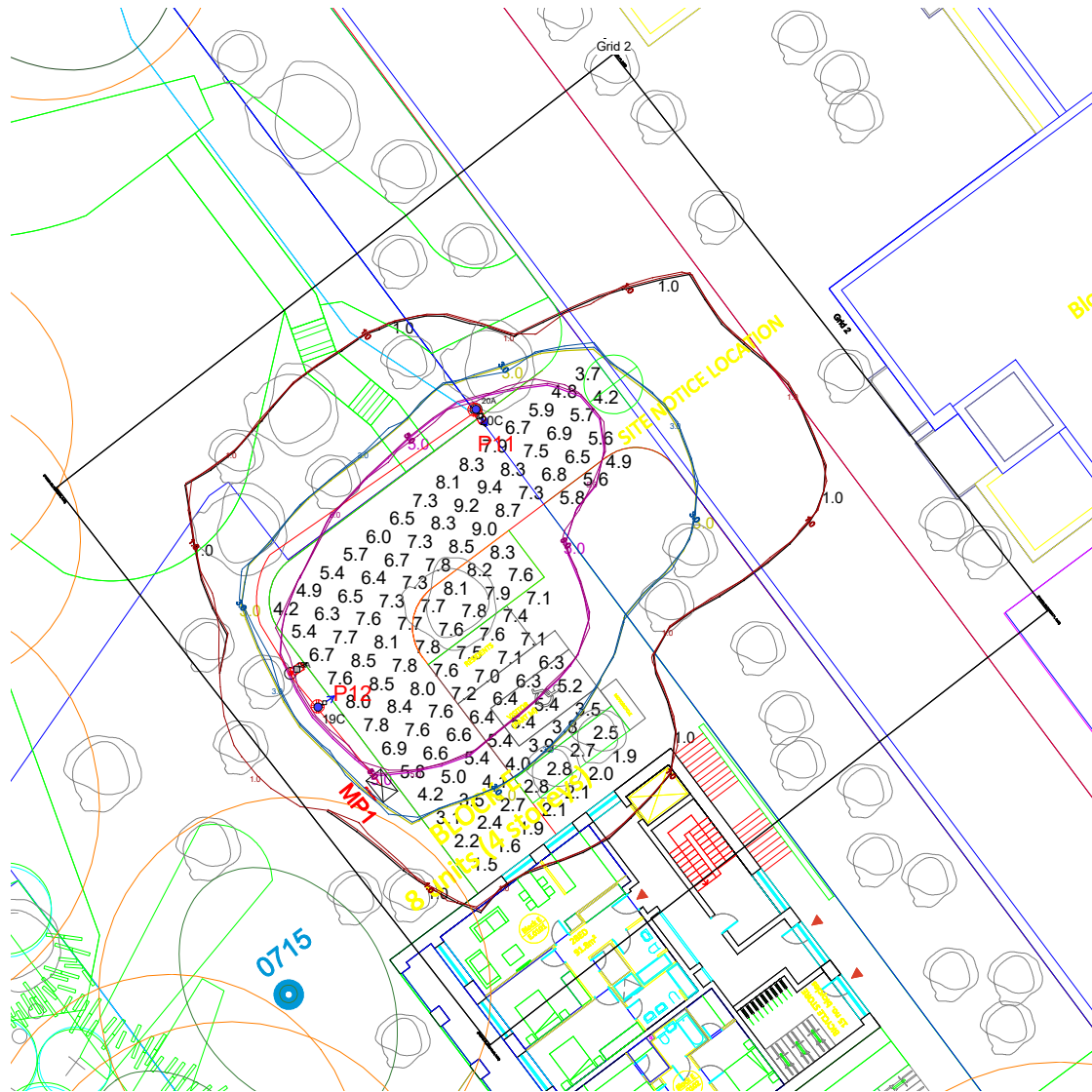

Results

Eav	6.12
Emin	1.50
Emax	9.35
Emin/Emax	0.16
Emin/Eav	0.25